

COMPARTMENT SIZE	3	4	5	6	7	8	9	10	11	12	13	14	15	16
DIMENSION (CLEAR)	1 $\frac{7}{8}$ "	2 $\frac{11}{16}$ "	3 $\frac{1}{2}$ "	4 $\frac{1}{4}$ "	5 $\frac{1}{16}$ "	5 $\frac{7}{8}$ "	6 $\frac{11}{16}$ "	7 $\frac{1}{2}$ "	8 $\frac{1}{4}$ "	9 $\frac{1}{16}$ "	9 $\frac{7}{8}$ "	10 $\frac{11}{16}$ "	11 $\frac{1}{2}$ "	12 $\frac{1}{4}$ "

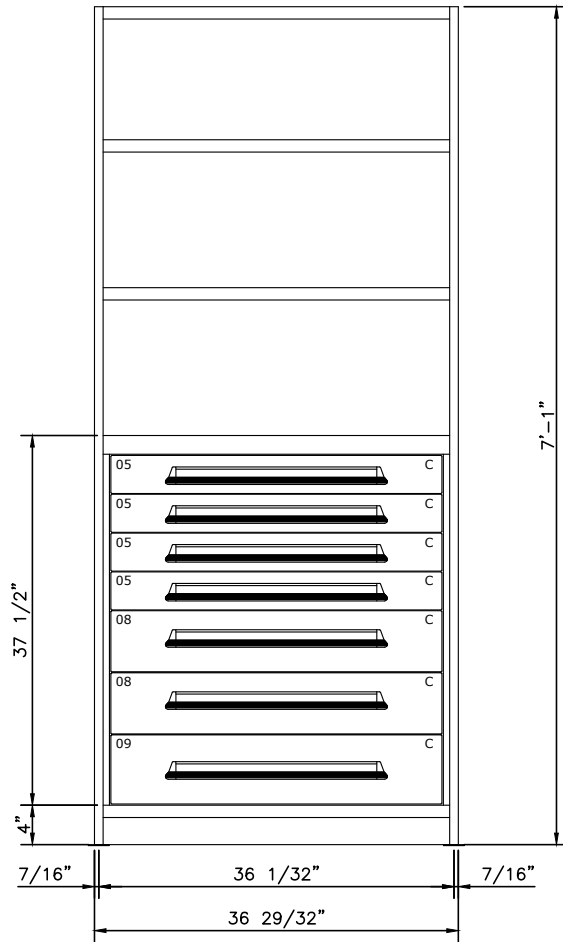

36" x 18" CLOSED SHELVING STARTER  
 BEADED POST AT FRONT  
 W/ 22GA. BOX SHELVES  
 500 LBS. CAPACITY PER SHELF  
 400 LBS. CAPACITY PER DRAWER

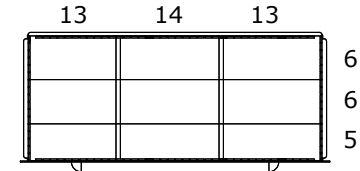
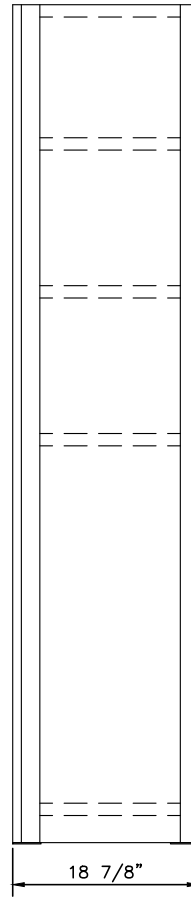

**DRAWER LAYOUT "C"**

9 COMPARTMENTS

PART NUMBER OPTIONS:

**DP115025** = PRE-ENGINEERED STARTER UNIT  
**DP115025A** = PRE-ENGINEERED ADD-ON UNIT

DRAWER NUMBER	04	05	06	07	08	09	10	11	12	13	14	15	16	17	18
USABLE HEIGHT	2 $\frac{1}{4}$ "	3"	3 $\frac{7}{8}$ "	4 $\frac{5}{8}$ "	5 $\frac{3}{8}$ "	6 $\frac{1}{4}$ "	7"	7 $\frac{3}{4}$ "	8 $\frac{1}{2}$ "	9 $\frac{3}{8}$ "	10 $\frac{1}{8}$ "	10 $\frac{7}{8}$ "	11 $\frac{3}{4}$ "	12 $\frac{1}{2}$ "	13 $\frac{1}{4}$ "
FRONT HEIGHT	3 $\frac{1}{16}$ "	3 $\frac{7}{8}$ "	4 $\frac{5}{8}$ "	5 $\frac{7}{16}$ "	6 $\frac{3}{16}$ "	7"	7 $\frac{3}{4}$ "	8 $\frac{9}{16}$ "	9 $\frac{3}{8}$ "	10 $\frac{1}{8}$ "	10 $\frac{7}{8}$ "	11 $\frac{3}{4}$ "	12 $\frac{1}{2}$ "	13 $\frac{5}{16}$ "	14 $\frac{1}{16}$ "

**Republic** 420 N. MAIN STREET  
 MONTGOMERY, IL 60538  
 (800) 477-1255  
 STORAGE PRODUCTS LLC. WWW.REPUBLICSTORAGE.COM

THIS DOCUMENT IS CONFIDENTIAL AND PROPRIETARY. NO PART OF THIS DOCUMENT MAY BE DISCLOSED IN ANY MANNER TO A THIRD PARTY WITHOUT THE PRIOR WRITTEN CONSENT OF REPUBLIC STORAGE PRODUCTS L.L.C.

DATE	DRAWN BY	CHECKED BY
7/7/23	JZ	.

DESCRIPTION

**PRE-ENGINEERED MODULAR  
 DRAWERS IN SHELVING**  
 (7) DRAWERS  
 (63) COMPARTMENTS

SHEET	DRAWING NUMBER	REV
1	DP115025	1